

LIVE-IN CABINS 88mm - 114mm

Come complete with:

- Wall logs
- Logs with Chalet cut for wind and rain resistant corners
- Tongued & grooved roof & floor boards
- High quality doors and windows
- Our houses are easy to install – there is a detailed installation manual in 5 languages in pack
- Option Roofing felt or shingles
- Pressure treated foundation joists
- Storm protection: wind braces or threaded rods (70 mm houses)
- Assembly kit

PRODUCTS

We are pleased to present a comprehensive range of Log Cabins, Weekend Houses and Saunas in many shapes and sizes. Our buildings are very flexible in that they all come in an easy to assemble self-build kit or can be erected by one of our team of fitters.

RAW MATERIAL

Our log cabins and garden houses are produced with high quality Nordic spruce, which is well known for its beneficial properties all over the world.

The cold winters and short summers of Scandinavia bring about a slow growth rate of timber, providing it with longevity and durability.

QUALITY SERVICE

Lakeland Log Cabins' ethos is quality first. Our cabins and saunas are second to none and we commit fully to the supply of products of which we are very proud.

DELIVERY

Local delivery is free. Extra charges may apply on some products to certain areas such as Scottish Highlands, Northern Island, Eire, Guernsey and Jersey. Please contact us if you are in any doubt.

CUSTOMER SERVICE

With Lakeland Log Cabins you will get a friendly, efficient, professional service.

- Investing in your well-being -



LAKELAND LOG CABINS

Live-in Cabins
(88mm - 114mm)

Lakeland Log Cabins
Cardewlees • Carlisle • CA5 6LG • Tel 01228 712401
Houghton Hall Garden Centre • Houghton • Carlisle • CA6 4JB • Tel 01228 539004

www.lakelandlogcabins.co.uk

We have a comprehensive range for all requirements.

Live-in Ten

88
 Area ca 58,5 m²
 Dimensions 1020x700 cm
 Ridge height ca 363 cm
 Side wall height ca 234 cm

114
 Area ca 58,5 m²
 Dimensions 1020x700 cm
 Ridge height ca 363 cm
 Side wall height ca 234 cm

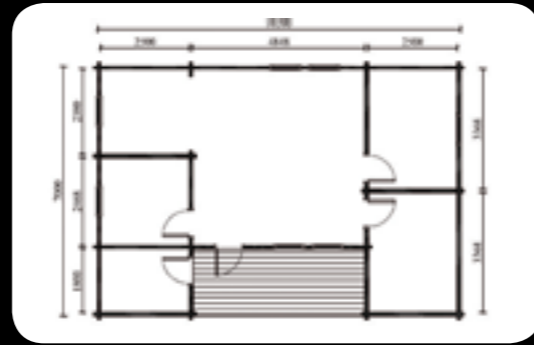

Live-in Thirteen

88
 Area ca 42 m²
 Canopy roof 120 cm
 Dimensions 1050x520 cm
 Ridge height ca 336 cm
 Side wall height ca 234 cm

114
 Area ca 42 m²
 Canopy roof 120 cm
 Dimensions 1050x520 cm
 Ridge height ca 336 cm
 Side wall height ca 234 cm

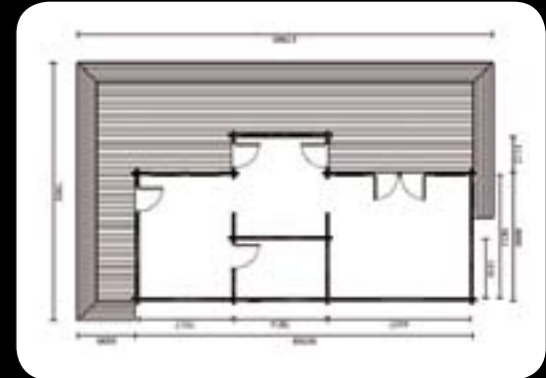

Live-in Eleven

88
 Area ca 40,5 m²
 Canopy roof 210 cm
 Dimensions 760x650 cm
 Ridge height ca 382 cm
 Side wall height ca 252 cm

114
 Area ca 40,5 m²
 Canopy roof 210 cm
 Dimensions 760x650 cm
 Ridge height ca 382 cm
 Side wall height ca 252 cm

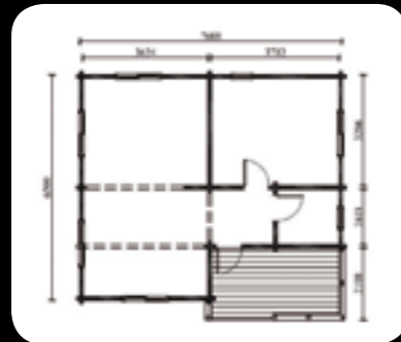

Live-in Fourteen

88
 Area ca 65 m²
 Canopy roof 240/130 cm
 Dimensions 1220x570 cm
 Ridge height ca 332 cm
 Side wall height ca 234/306 cm

114
 Area ca 65 m²
 Canopy roof 240/130 cm
 Dimensions 1220x570 cm
 Ridge height ca 332 cm
 Side wall height ca 234/306 cm



Live-in Twelve

88
 Area ca 19,4 m²
 Dimensions 620x340 cm
 Ridge height ca 320 cm
 Side wall height ca 234/286 cm

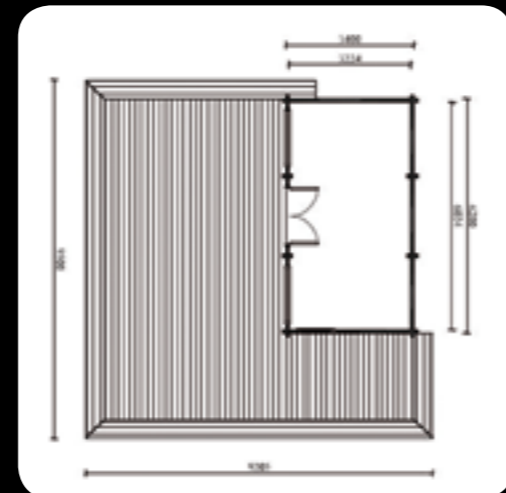

Live-in Fifteen

88
 Area ca 33 m²
 Canopy roof 170 cm
 Dimensions 720x487 cm
 Ridge height ca 543 cm
 Side wall height ca 270 cm

114
 Area ca 33 m²
 Canopy roof 170 cm
 Dimensions 720x487 cm
 Ridge height ca 543 cm
 Side wall height ca 270 cm

